

Residential Shade Tree Rebate Application

Roseville Shade Tree Rebate Program

Quick facts about rebate processing:

1. This rebate will be mailed to the Payee.
2. Please allow 6-8 weeks for processing.
3. Final determination of rebate eligibility will be governed by the Terms and Conditions of the Roseville Shade Tree Rebate Program.

PRIMARY ACCOUNT HOLDER			
Roseville Utility Account Number			
Name			
Email Address (required)			
Installation address			
City	State	Zip	Telephone

PAYEE			
<input type="checkbox"/> Landlord <input type="checkbox"/> Primary Account Holder			
Name			
Email Address (required)			
Mailing Address			
City	State	Zip	Telephone

TREES PURCHASED			
TREE NAME (AVAILABLE ON TREE TAGS OR LABEL ON THE POT)			LOCATION PLANTED
Name	Date Purchased	Purchase Price	Location of Planting <i>(South, East or West of home. Trees planted on the North do not qualify)</i>

CHECKLIST:

- Paid-in-Full invoice or receipt including Contractor/Retailer information
- Completed and Signed application

REQUIREMENTS:

1. Maximum of 6 trees per residence.
2. Valid for purchases from **July 1, 2013 to June 30, 2014** or until funds are depleted.
3. All applications must be postmarked no later than **60 days after purchase**.
4. Offer only valid for the purchase of trees from the list on reverse side. Some trees are rebated at \$25.00 and some at \$50.00 each.
5. All trees must be planted at a single-family residence receiving electricity from Roseville Electric and must be purchased new at retail price.

HOW TO APPLY:

1. Visit us at www.roseville.ca.us/rebates or call us at (916) 79-POWER before purchase or planting to verify current rebate amounts and information.
2. **Submit documentation to: Roseville Electric Rebate Program, 2090 Hilltop Cir. Roseville, CA 95747 or Fax to: (916)784-3797. Please do not include it with your utility bill.**

TERMS & CONDITIONS:

1. By applying for this rebate you acknowledge that the rebate influenced your decision to install the energy efficient measure at your residence.
2. Customers may be eligible for additional rebates if there is a change in residence.
3. Rebates may not exceed the cost of the energy efficient equipment.
4. Roseville Electric disclaims any and all liability, loss or damage that may arise as a result of the applicant's or contractor's participation in this program.
5. Roseville Electric is not responsible for items lost or delayed in the mail, nor any remittance delayed due to incorrect rebate applications.
6. Roseville Electric is not responsible for any taxes that may be imposed as a result of your receipt of any financial rebates from Roseville Electric.
7. Roseville Electric reserves the right to verify both the efficiency and installation of equipment.
8. Roseville Electric may share my name, address, electricity usage or other needed information with a consultant for the purpose of on-site pre and post inspection.

SIGNATURE REQUIRED:

X
Purchaser Signature (REQUIRED) _____ Date _____

Explanation (if needed) _____ Rev. 10/12

For a list of qualifying trees, please visit www.roseville.ca.us/shadetree

For more information please call Roseville Electric at (916) 79-POWER (797-6937) www.roseville.ca.us/rebates

Snap here for
Rebate Amounts



Roseville Electric

Residential Shade Tree Rebate Application

Roseville Shade Tree Rebate Program



Before digging, where there normally might be underground utilities; (typically in front yards) make a toll-free call to Underground Service Alert (USA). Within 2 working days utilities locations will be identified and you will be cleared to dig. *USA service at no charge

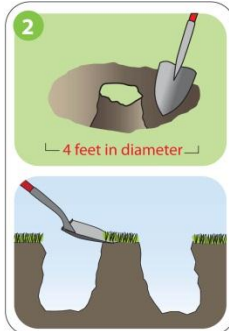

Dig a wide hole leaving the center as a pedestal. The pedestal will be shortened when you plant the tree. It gives the tree a stable platform. The surrounding "moat" helps distribute water around the tree and helps the roots grow down.

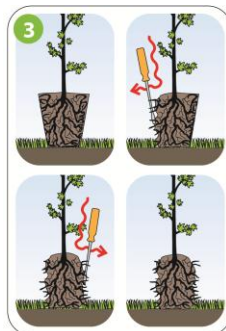

Remove the tree from the container. Spread the roots out so they are pointing outward, not circling around. Circling roots do not provide adequate support for a growing tree. You can cut larger circling roots with pruning shears or a sharp knife.

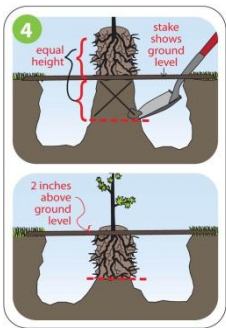

Put tree on pedestal using the stake for a guide; shorten the pedestal until the top of the root ball sits about 2 inches above the ground.

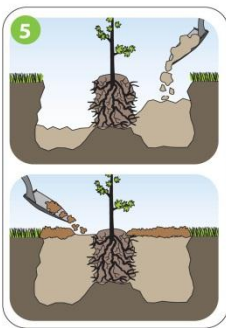

Fill the hole with the same soil you removed from the hole. If desired, thoroughly mix in up to 15 percent of compost of planting mix. Cover the soil with 3 to 4 inches of mulch, being careful not to cover the root ball.

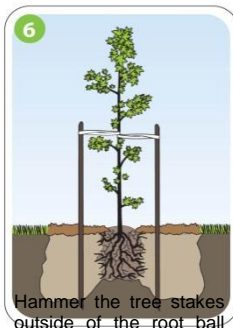

Hammer the tree stakes outside of the root ball and away from the branches. Remove the stake that is tied directly to the trunk. Tie the tree to the stakes, leaving room for the tree to sway. It may require two sets of ties to keep the trunk vertical.

General Recommendations for Tree Placement

- ✓ Trees on the east side of the home provide morning shade
- ✓ Narrow trees may be placed closer to the home
- ✓ Do not block your or your neighbor's solar system
- ✓ Shade your Air Conditioner
- ✓ Place small trees in small spaces
- ✓ Place large trees in large spaces

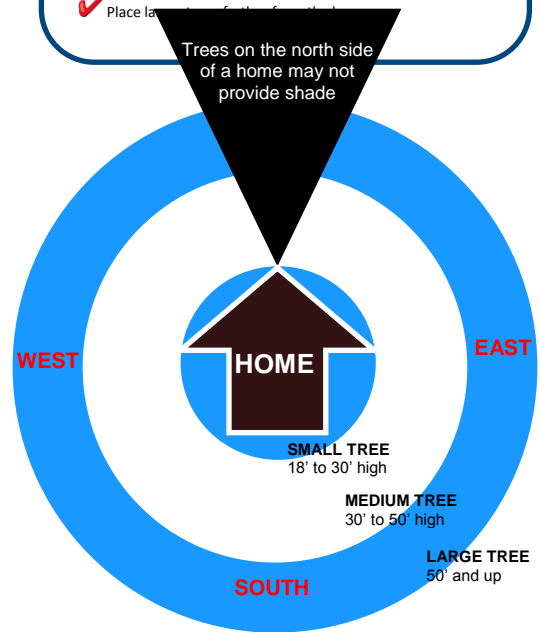

For more information please call Roseville Electric at (916) 79-POWER (797-6937) www.roseville.ca.us/rebates

Snap here for Rebate Amounts



Roseville Electric